

## FLEX-PRO A3 & A4

Feed Rates to 158.5 GPH  
 Pressures to 125 PSI  
 2500:1 Turndown ratio  
 Tube Failure Detection  
 Brushless DC Motor  
 NEMA 4X (IP 66) Washdown  
 2 Year Warranty



Model A4

Model A3

**NEMA 4X** **CE**



Exclusive:  
**TFD system**  
 Tube Failure Detection

Patents: 8,215,931 - 7,284,964 - 7,001,153 - 4,496,295 and other patents pending

### Applications:

- Chemical Metering
- Wastewater Treatment
- Chlorination
- Chloramination
- Fluoridation
- Polymer Injection
- Pulp & Paper Slurries
- Printing Inks
- Oil Based Fluids
- Gaseous Fluids
- Shear Sensitive Fluids
- Caustics
- Chemical Slurries
- Food and Beverage

### Features:

- Peristaltic pump design does not have valves that can clog requiring maintenance.
- Self priming - even against maximum line pressure. By-pass valves are not required. Cannot vapor lock or lose prime.
- Output rates to: 158.5 GPH (600 LPH) and pressures to 125 PSI (8.6 Bar).
- No maintenance brushless variable speed motor.
- Specially engineered tubing for long life at high pressures. Meets FDA 21 CFR requirements for food contact applications.
- Patented Tube Failure Detection (TFD) system. Senses tube failure by detecting chemical in the pump head. No false triggering.
- 2500:1 turndown ratio.
- SCADA Inputs include: 4-20mA, 0-10Vdc, and Pulse inputs for remote external speed control and 0-30 VDC / contact closure remote start/stop.
- Operator friendly digital touch pad with menu driven software.
- VGA Graphic multi-color backlit LCD displays remote/local control status, motor speed, output rate, input signal values, service and alarm status.
- Outputs include: Scalable 4-20mA or pulse, one 250V/6A relay and three 115V/1A contact closures assignable to monitor up to 17 different pump functions including TFD, FVS, remote/local control setting, motor on, fault, current operating mode, and others.
- Two CNC precision machined squeeze rollers and two alignment rollers for optimum squeeze, unparalleled accuracy, and tube life.
- Heavy duty rotor - single piece plastic rotor means no flexing and increased accuracy with no metal springs or hinges to corrode.
- Inject at maximum pressure in either direction (clockwise and counter clockwise).
- Patented feature to extended tube life.
- Compatible with Blue-White's output Flow Verification Sensor (FVS) system.

### Engineering Specifications:

**Maximum working pressure (excluding pump tubes):**

125 psig (8.6 bar)

Note: see individual pump tube assembly maximum pressure ratings.

**Maximum Fluid temperature (excluding pump tubes):**

3/8" OD x 1/4" ID tubing connections: 130° F (54° C)

M/NPT connections: 185° F (85° C)

Note: see individual pump tube assembly maximum temperature ratings.

**Ambient Operating Temperature**

14°F to 115°F (-10°C to 46°C)

**Ambient Storage Temperature**

-40°F to 158°F (-40°C to 70°C)

**Operating Voltage:**

A3 MODELS: 96 to 264VAC-50/60Hz, 220W

A4 MODELS: 96 to 264VAC-50/60Hz, 350W

**Power Cord Options:**

115V60Hz = NEMA 5/15 (USA)

230V60Hz = NEMA 6/15 (USA)

220V50Hz = CEE 7/II (EU)

240V50Hz = AS 3112 (Australia/New Zealand)

**Enclosure:**

NEMA 4X (IP66), Polyester powder coated aluminum.

Maximum Overall Dimensions:

A3 models: 8-1/8"W x 10-3/4"H x 15-1/4"D (20.6W x 27.3H x 38.9D cm)

A4 models: 12-1/8"W x 14-1/4"H x 18-5/8"D (30.8W x 36.1H x 47.3D cm)

**Approximate shipping wt:**

A3 models: 33 lb. (15.0 Kg)

A4 models: 58 lb. (26.3 Kg)

**Motor speed adjustment range:**

2,500:1 (0.04% - 100% motor speed)

**Motor speed adjustment resolution:**

0.1% increments > 10% motor speed

0.01% increments > 1% motor speed and < 10%

0.001% increments < 1% motor speed

**Maximum viscosity:**

12,000 Centipoise

**Maximum suction lift:**

30 ft. Water, 0 psig (4.5 m, 0 bar)

**Display**

3 color VGA backlit LCD, UV resistant.

**Display Resolution**

0.1 > 10% motor speed

0.01 > 1% motor speed and < 10%

0.001 < 1% motor speed

**Display Languages**

English, Spanish, French or German selectable.

**Keypad**

Ten button positive action tactile switch keypad.

**Security**

Programmable 4-digit password.

### Materials of Construction:

**Wetted components:****Pump Tube Assembly (Model Specific - 2 provided):**

Tubing: . . . . . Norprene® or Norprene® Chemical or Tygothane®

Adapter fittings: .PVDF

**Injection / Back-flow Check valve:**

Body & insert: . . . . . PVDF

Check Ball: . . . . . Ceramic

Spring: . . . . . Hastelloy C-276

Ball Seat O-ring: . . . . . Viton® (optional EP)

Static Seal O-ring: . . . . . Viton® (optional EP)

Duckbill anti-scale valve: Santoprene®

**Ancillary Items provided****For "S" tubing type connections only:**

(Available on M3 only)

Suction Tubing: . . . . . 3/8" OD x 1/4" ID x 10' Clear PVC

Discharge Tubing: . . . . . 3/8" OD x 1/4" ID x 10' Polyethylene (LLDPE)

Suction Strainer: . . . . . Polypropylene

**For "B" barb tubing and "M" M/NPT connections only:**

(Available on M-4 only)

**Suction Strainer:**

Body: . . . . . PVDF

Check Ball: . . . . . Ceramic

Ball Seat O-ring: . . . . . Viton® (optional EP)

**For "C" Tri-clamp connections only:**

(Available on M3 only)

none

**Non-Wetted components:****Enclosure:**

413 Aluminum (Polyester powder coated)

**Pump Head:**

Valox® (PBT) thermoplastic

**Pump Head Cover:**

Clear Acrylic - Annealed for added strength and chemical resistance.

Permanently lubricated sealed motor shaft support ball bearing.

Brass shaft support bearing retainer.

**Cover Screws:**

Stainless Steel

**Roller Assembly:**

Rotor:.....Valox® (PBT)

Rollers: .....Nylon

Roller Bearings: .....SS Ball Bearings

**Motor Shaft:**

Chrome plated steel

**TFD System Sensor pins:**

Hastelloy C-276

**Power Cord:**

3 conductor, SJTW-A Water-resistant

**Tube Installation Tool:**

GF Nylon

**Mounting Brackets and Hardware:**

316 Stainless Steel

**Output Specifications:**

Feed Rate			Max Speed	Max Pressure	Max Temperature	A3 Model Numbers		
<b>Norprene® A3 Tube Pumps</b>								
Meets FDA criteria for food   Excellent chemical resistance   CIP   SIP								
GPH	LPH	ML/Min	RPM	PSI (bar)	F (C)	115V AC	230V AC	220V AC
.001 - 2.10	.003 - 7.8	.05 - 132	125	125 (8.6)	185 (85)	A3V24-*ND	A3V25-*ND	A3V26-*ND
.003 - 7.90	.012 - 30.0	.2 - 500	125	125 (8.6)	185 (85)	A3V24-*NF	A3V25-*NF	A3V26-*NF
.007 - 17.4	.026 - 66.0	.4 - 1097	125	125 (8.6)	185 (85)	A3V24-*NH	A3V25-*NH	A3V26-*NH
.010 - 25.3	.038 - 96.0	.6 - 1596	125	125 (8.6)	185 (85)	A3V24-*NJ	A3V25-*NJ	A3V26-*NJ
.013 - 33.3	.050 - 126	.8 - 2100	125	125 (8.6)	185 (85)	A3V24-*NK	A3V25-*NK	A3V26-*NK
<b>Norprene® A3 Tube Pumps</b>								
Meets FDA criteria for food   Excellent chemical resistance   Extra long life at low pressures								
GPH	LPH	ML/MIN	RPM	PSI (bar)	F (C)	115V AC	230V AC	220V AC
.013 - 33.3	.050 - 126	.8 - 2100	125	30 (2.1)	185 (85)	A3V24-*NKL	A3V25-*NKL	A3V26-*NKL
.007 - 17.4	.026 - 66.0	.4 - 1097	125	65 (4.5)	185 (85)	A3V24-*NHL	A3V25-*NHL	A3V26-*NHL
<b>Norprene® Chemical A3 Tube Pumps</b>								
Meets FDA criteria for food   Superior chemical resistance								
GPH	LPH	ML/Min	RPM	PSI (bar)	F (C)	115V AC	230V AC	220V AC
.006 - 14.5	.022 - 55.1	.4 - 920	125	50 (3.4)	130 (54)	A3V24-*TH	A3V25-*TH	A3V26-*TH
.011 - 28.5	.043 - 108.0	.7 - 1800	125	50 (3.4)	130 (54)	A3V24-*TK	A3V25-*TK	A3V26-*TK
<b>Tygothane® A3 Tube Pumps</b>								
Meets FDA criteria for food   Resistant to oils, greases and fuels								
GPH	LPH	ML/Min	RPM	PSI (bar)	F (C)	115V AC	230V AC	220V AC
.002 - 4.6	.007 - 17.4	.1 - 290	125	65 (4.5)	130 (54)	A3V24-*GE	A3V25-*GE	A3V26-*GE
.004 - 10.1	.015 - 38.4	.3 - 637	125	65 (4.5)	130 (54)	A3V24-*GG	A3V25-*GG	A3V26-*GG
.010 - 24.9	.038 - 94.2	.6 - 1570	125	65 (4.5)	130 (54)	A3V24-*GH	A3V25-*GH	A3V26-*GH
.011 - 28.5	.043 - 108.0	.7 - 1800	125	65 (4.5)	130 (54)	A3V24-*GK	A3V25-*GK	A3V26-*GK
Feed Rate			Max Speed	Max Pressure	Max Temperature	A4 Model Numbers		
<b>Norprene® A4 Tube Pumps</b>								
Meets FDA criteria for food   Excellent chemical resistance   CIP   SIP								
GPH	LPH	ML/Min	RPM	PSI (bar)	F (C)	115V AC	230V AC	220V AC
.01 - 28.5	.04 - 108	.7 - 1800	125	125 (8.6)	185 (85)	A4V24-*NH	A4V25-*NH	A4V26-*NH
.02 - 44.4	.07 - 168	1.1 - 2800	125	100 (6.9)	185 (85)	A4V24-*NJ	A4V25-*NJ	A4V26-*NJ
.02 - 50.7	.08 - 192	1.3 - 3200	125	80 (5.5)	185 (85)	A4V24-*NK	A4V25-*NK	A4V26-*NK
.02 - 54.0	.09 - 204	1.4 - 3400	125	100 (6.9)	185 (85)	A4V24-*NHH	A4V25-*NHH	A4V26-*NHH
.04 - 100.0	.15 - 378	2.5 - 6300	125	50 (3.4)	185 (85)	A4V24-*NL	A4V25-*NL	A4V26-*NL
.06 - 158.5	.24 - 600	4.0 - 10000	125	30 (2.0)	185 (85)	A4V24-*NP	A4V25-*NP	A4V26-*NP
<b>Norprene® A4 Low Pressure Tube Pumps</b>								
Meets FDA criteria for food   Excellent chemical resistance   Extra long life at low pressures								
GPH	LPH	ML/Min	RPM	PSI (bar)	F (C)	115V AC	230V AC	220V AC
.02 - 50.7	.07 - 192	1.3 - 3200	125	30 (2.1)	185 (85)	A4V24-*NKL	A4V25-*NKL	A4V26-*NKL
.04 - 111	.17 - 420	2.8 - 7000	125	30 (2.1)	185 (85)	A4V24-*NKKL	A4V25-*NKKL	A4V26-*NKKL
<b>Norprene® Chemical A4 Tube Pumps</b>								
Meets FDA criteria for food   Superior chemical resistance								
GPH	LPH	ML/Min	RPM	PSI (bar)	F (C)	115V AC	230V AC	220V AC
.01 - 20.6	.03 - 78	.5 - 1300	125	30 (2.1)	130 (54)	A4V24-*TH	A4V25-*TH	A4V26-*TH
.02 - 42.8	.06 - 162	1.1 - 2700	125	30 (2.1)	130 (54)	A4V24-*TK	A4V25-*TK	A4V26-*TK
.02 - 50.7	.08 - 192	1.3 - 3200	125	30 (2.1)	130 (54)	A4V24-*THH	A4V25-*THH	A4V26-*THH
<b>Tygothane® A4 Tube Pumps</b>								
Meets FDA criteria for food   Resistant to oils, greases and fuels								
GPH	LPH	ML/Min	RPM	PSI (bar)	F (C)	115V AC	230V AC	220V AC
.01 - 39.6	.06 - 150	1.0 - 2500	125	65 (4.5)	130 (54)	A4V24-*GH	A4V25-*GH	A4V26-*GH
.02 - 55.5	.09 - 210	1.4 - 3500	125	65 (4.5)	130 (54)	A4V24-*GK	A4V25-*GK	A4V26-*GK
.04 - 100	.20 - 378	2.5 - 6300	125	65 (4.5)	130 (54)	A4V24-*GKK	A4V25-*GKK	A4V26-*GKK

- The Flex-Pro Pump's motor speed is linear over the entire 0.05% to 100% adjustment range.
- Output versus pressure is nearly linear in all models. Larger tubes exhibit greater losses.
- See the instruction manual for output versus viscosity curves.
- For optimum tube life, specify the pump to operate at the lowest possible RPM and pressure.
- Output based on testing with water at 72 F, 5 foot suction lift, atmospheric conditions at sea level.
- \* Inlet/outlet connection type  
 S = 3/8" OD x 1/4" ID tubing compression type connections (A3 model only)  
 M = 1/2" male NPT (available on A3 & A4 models)  
 B = 1/2" ID tubing barb type connections (available on A4 models only)  
 C = 3/4" tri-clamp connections (available on A3 models only)

**Chemical Resistance of Tubing:**

**Norprene® Tubing**

Meets FDA criteria for food | Excellent chemical resistance

Alcohol general	Citric Acid 50%	Hydrochloric acid 33%	Potassium hydroxide
Aluminum Sulfate (Alum)	Ethylene glycol	Hydrocyanic acid	Potassium permanganate 40%
Ammonium chloride	Ferric chloride	Hydrogen peroxide	Propylene glycol
Ammonium hydroxide	Ferric nitrate	Hypochlorous acid	Sodium hydroxide 50%
Ammonium Sulfate (LAS)	Ferric sulfate	Iodine	Sodium Bisulfite
Benzyl alcohol	Ferrous chloride - 43% in water	Magnesium chloride	Sodium Chlorite 12%
Bleach	Ferrous sulfate	Magnesium sulfate	Sodium Hypochlorite 12.5%
Brine solutions	Fluosilicic Acid (up to 25%)	Phosphoric acid	Sodium sulfide
Calcium Hydroxide 10% (Lime Slurry)	Formic acid	Plating solutions	Sulfuric acid up to 50%
Calcium hypochlorite 20%	Glucose	Polyaluminum Chloride (PAC)	Tannic acid

**Norprene® Chemical Tubing - Ultra smooth plasticizer-free bore (inner liner)**

Meets FDA criteria for food | Superior chemical resistance

Ferrous Chloride (up to 40%)	Phosphoric Acid (up to 85%)	Bases	Applications: Ink and solvent production Battery acid filling Specialty chemical production / processing Sensitive fluid transfer
Fluoboric Acid (up to 48%)	Potassium Hypochlorite (up to 70%)	Salts	
Fluosilicic Acid (up to 25%)	Sodium Phosphate (up to 30%)	Ketones	
Hydrofluoric Acid (up to 48%)	Sulfuric Acid (up to 98%)	Alcohols	
Nitric Acid (up to 71%)		Isobutyl Alcohol	

**Tygothane® Tubing**

Meets FDA criteria for food | Resistant to oils, greases and fuels

Cyclohexane	Kerosene	Oils:	Oils:
Diesel Fuel	Lard	ASTM reference No.1,2,3	Linseed
Fatty acids	Mineral spirits	Castor	Lubricating
Gasoline	Soap solutions	Coconut	Mineral
Heptane	Turpentine	Fuel	
Hexane			

Norprene® is a registered trademark of Saint-Gobain.  
Tygothane® is a registered trademark of Saint-Gobain.

**Pump Tube Assembly Output Specifications:**

**Model A3 - Available Pump Tubes and Output Ranges**

Tube Material	Tube Size	Max Pressure	Max Temp	Required Roller Part Number	Output Range		
Material	Code	PSI (bar)	F (C)		GPH	LPH	ML/Min
Norprene	ND	125 (8.6)	185 (85)	A3-ND-R	.001 - 2.1	.003 - 7.8	.05 - 132
Norprene	NF	125 (8.6)	185 (85)	A3-ND-R	.003 - 7.9	.012 - 30.0	.2 - 500
Norprene	NH	125 (8.6)	185 (85)	A3-NH-R	.007 - 17.4	.026 - 66.0	.4 - 1097
Norprene	NHL	65 (4.5)	185 (85)	A3-NH-R	.007 - 17.4	.026 - 66.0	.4 - 1097
Norprene	NJ	125 (8.6)	185 (85)	A3-NH-R	.010 - 25.3	.038 - 96.0	.6 - 1596
Norprene	NK	125 (8.6)	185 (85)	A3-NH-R	.013 - 33.3	.050 - 126.0	.8 - 2100
Norprene	NKL	30 (2.1)	185 (85)	A3-NH-R	.013 - 33.3	.050 - 126.0	.8 - 2100
Norprene Chemical	TH	50 (3.4)	130 (54)	A3-TH-R	.006 - 14.5	.022 - 55.1	.4 - 920
Norprene Chemical	TK	50 (3.4)	130 (54)	A3-TH-R	.011 - 28.5	.043 - 108.0	.7 - 1800
Tygothane	GE	65 (4.5)	130 (54)	A3-GE-R	.002 - 4.60	.007 - 17.4	.1 - 290
Tygothane	GG	65 (4.5)	130 (54)	A3-GE-R	.004 - 10.1	.015 - 38.4	.3 - 637
Tygothane	GH	65 (4.5)	130 (54)	A3-GE-R	.010 - 24.9	.038 - 94.2	.6 - 1570
Tygothane	GK	65 (4.5)	130 (54)	A3-GE-R	.011 - 28.5	.043 - 108.0	.7 - 1800

**Model A4 - Available Pump Tubes and Output Ranges**

Tube Material	Tube Size	Max Pressure	Max Temp	Required Roller Part Number	Output Range		
Material	Code	PSI (bar)	F (C)		GPH	LPH	ML/Min
Norprene	NH	125 (8.6)	185 (85)	A4-NH-R	.01 - 28.5	.04 - 108	.7 - 1800
Norprene	NJ	100 (6.9)	185 (85)	A4-NH-R	.02 - 44.4	.07 - 168	1.1 - 2800
Norprene	NK	80 (5.5)	185 (85)	A4-NH-R	.02 - 50.7	.08 - 192	1.3 - 3200
Norprene	NHH	100 (6.9)	185 (85)	A4-TH-R	.02 - 54.0	.09 - 204	1.4 - 3400
Norprene	NL	50 (3.4)	185 (85)	A4-NL-R	.04 - 100.0	.15 - 378	2.5 - 6300
Norprene	NP	30 (2.1)	185 (85)	A4-NL-R	.06 - 158.5	.24 - 600	4.0 - 10000
Norprene	NKL	30 (2.1)	185 (85)	A4-TH-R	.02 - 50.7	.08 - 192	1.3 - 3200
Norprene	NKKL	30 (2.1)	185 (85)	A4-TH-R	.04 - 111	.17 - 420	2.8 - 7000
Norprene Chemical	TH	30 (2.1)	130 (54)	A4-TH-R	.01 - 20.6	.03 - 78	.5 - 1300
Norprene Chemical	TK	30 (2.1)	130 (54)	A4-TH-R	.02 - 42.8	.06 - 162	1.1 - 2700
Norprene Chemical	THH	30 (2.1)	130 (54)	A4-TH-R	.02 - 50.7	.08 - 192	1.3 - 3200
Tygothane	GH	65 (4.5)	130 (54)	A4-GH-R	.01 - 39.6	.06 - 150	1.0 - 2500
Tygothane	GK	65 (4.5)	130 (54)	A4-GH-R	.02 - 55.5	.09 - 210	1.4 - 3500
Tygothane	GKK	65 (4.5)	130 (54)	A4-GH-R	.04 - 100	.20 - 378	2.5 - 6300

# FLEX-PRO® Peristaltic Metering Pump

## Engineering and Technical Data

### Dimensions:

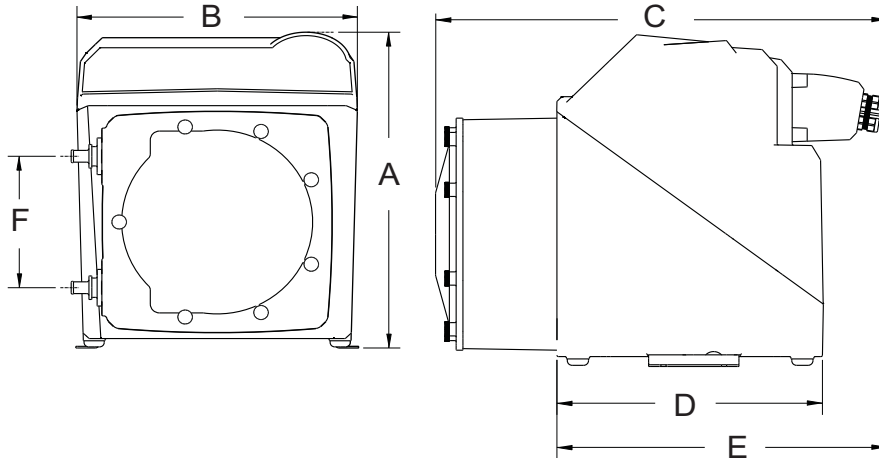

Dim	A3 Series		A4 Series	
	Inches	cm	Inches	cm
A	10-3/4"	27.3	14-1/4"	36.1
B	8-1/8"	20.6	12-1/8"	30.8
C	15-1/4"	38.9	18-5/8"	47.3
D	10"	25.4	11"	27.9
E	12-1/4"	31.0	13-5/8"	34.6
F	4-1/4"	10.7	6"	15.2

### Model Number Matrix:

Flex-Pro Model Number								
<b>A3</b>	Flex-Pro A3 Peristaltic Metering Pump							
<b>A4</b>	Flex-Pro A4 Peristaltic Metering Pump							
<b>Series</b>								
<b>F</b>	Single manual output control (manual/local control only)							
<b>V</b>	Multiple automatic input output control and alarm modes (remote control)							
<b>Maximum Motor Speed</b>								
<b>2</b>	125 RPM (maximum rotor rotation speed)							
<b>Power Cord (operating voltage requirement 96VAC to 264VAC)</b>								
<b>4</b>	115V / 60Hz, power cord NEMA 5/15 plug (US)							
<b>5</b>	230V / 60Hz, power cord NEMA 6/15 plug (US)							
<b>6</b>	220V / 50HZ, power cord CEE 7/VII plug (EU)							
<b>8</b>	240V / 50HZ, power cord AS 3112 plug (Australia/New Zealand)							
<b>X</b>	No Power Cord							
<b>Inlet/Outlet Connection Size, Connection Type, Connection Material</b>								
<b>S</b>	3/8" OD x 1/4" ID Tube Compression Fitting, Natural PVDF (Kynar), available on A3 models only							
<b>M</b>	1/2" Male NPT Fitting, Natural PVDF (Kynar), available on A3 & A4 models							
<b>B</b>	1/2" ID Tubing Barb Fitting, Natural PVDF (Kynar), available on A4 models only							
<b>C</b>	3/4" Tri-clamp connections, Natural PVDF (Kynar), available on A3 models only							
<b>Pump Tube Material, Pump Tube Size</b>								
<b>ND</b>	Norprene® .075 ID - A3 models only	<b>TH</b>	Norprene® Chemical .250 ID					
<b>NF</b>	Norprene® .155 ID - A3 models only	<b>THH</b>	Norprene® Chemical .250 ID (Dual Tube) - A4 models only					
<b>NH</b>	Norprene® .250 ID	<b>TK</b>	Norprene® Chemical .375 ID					
<b>NHL</b>	Norprene® .250 ID (65 PSI max pressure - longer life)	<b>TKK</b>	Norprene® Chemical .375 ID (Dual Tube) - A4 models only					
<b>NHH</b>	Norprene® .250 ID (Dual Tube) - A4 models only	<b>GE</b>	Tygothane® .125 ID - A3 models only					
<b>NJ</b>	Norprene® .312 ID	<b>GG</b>	Tygothane® .187 ID - A3 models only					
<b>NK</b>	Norprene® .375 ID	<b>GH</b>	Tygothane® .312 ID					
<b>NKL</b>	Norprene® .375 ID (30 PSI max pressure - longer life)	<b>GHH</b>	Tygothane® .312 ID (Dual Tube) - A4 models only					
<b>NKKL</b>	Norprene® .375 ID (30 PSI max - Dual Tube) - A4 models only	<b>GK</b>	Tygothane® .375 ID					
<b>NL</b>	Norprene® .500 ID - A4 models only	<b>GKK</b>	Tygothane® .375 ID (Dual Tube) - A4 models only					
<b>NP</b>	Norprene® .750 ID - A4 models only							
<b>Options (leave this blank for standard model with left facing head)</b>								
<b>1</b>	TI40-6V Threadless injection check valve, replaces A-104NK-6A threaded check valve							
<b>2</b>	C340A Foot valve, replaces standard C-342 inlet strainer (no check valve)							
<b>R</b>	Right facing pump head, input / output (Left facing fluid input / output is standard)							
<b>D</b>	Down facing pump head, input / output (Left facing fluid input / output is standard)							
<b>A3</b>	<b>V</b>	<b>2</b>	<b>4</b>	<b>-</b>	<b>S</b>	<b>NH</b>		<b>Sample Model Number</b>

## Features list:

Feature
TFD (Tube Failure Detection) System Alarm
FVS (Flow Verification System) Alarm *
Motor reverse (rotor reversible)
Three position pump head rotation
Tube life timer
Output: One, 6 amp alarm relay
Output: Three, dry contact or maximum 30VDC/115VAC 1 amp contact closures
Output: Programmable 4-20mA signal or high speed pulse, proportional to pump output
Input: One, contact closure (remote start / stop)
Input: Remote speed control via 4-20mA, 0-10VDC, high speed digital pulse, contact closure pulse
Remote/Local control settings
Password protection
Display: Motor speed, Tube Failure Detection (TFD) system and Flow Verification System (FVS) alarm status
Display: Output in ml/min, oz/min, L/hr, Gal/hr, Gal/day, RPM, and input signal values
Automated PPM chemical dosing system
<b>Available Operating Modes:</b>
Manual (local): speed adjustment
Remote input: 4-20mA
Remote input: 0-10 VDC
Remote input: high speed frequency (pulse) input
Remote input: pulse triggered batch dispensing
Remote input: proportional PPM (parts per million) dosing with high speed frequency (pulse) input
Manual (local): batch dispensing
Manual (local): repeating cycle timer
Manual (local): fixed speed PPM (parts per million) dosing

\* Requires Micro-Flo Sensor sold separately

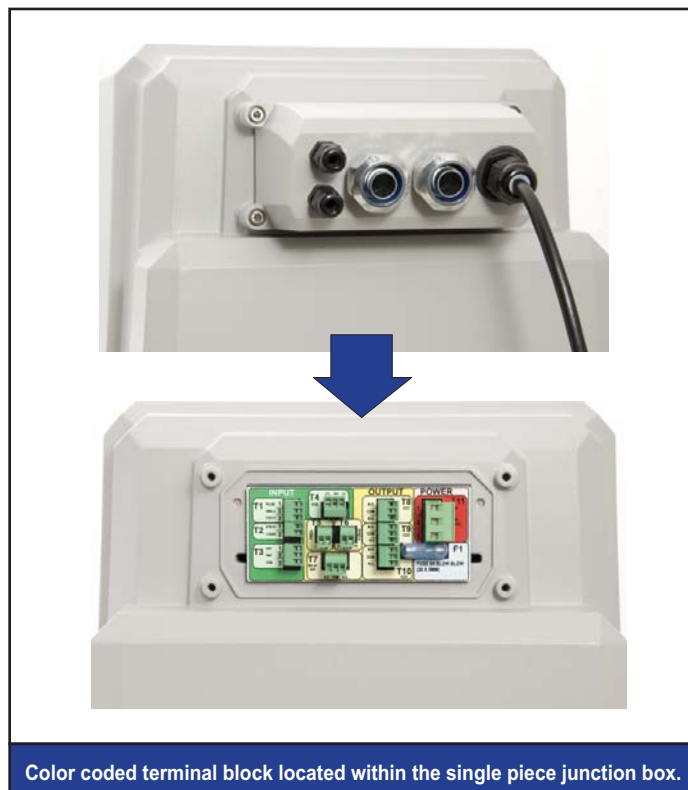

Color coded terminal block located within the single piece junction box.